



**BLACKSHOW
AFRICA**

POWER TRANSMISSION PARTS

Spare parts in-stock when you need them

V PULLEYS



www.blackshowafrica.co.za

V Belt Pulleys SPZ | Taper Bush to ISO4183 and DIN2211

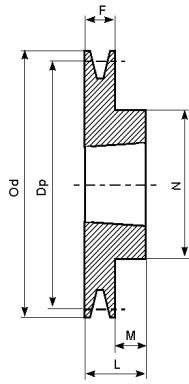

Form 1

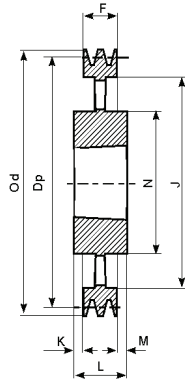

Form 4

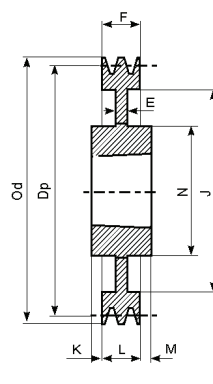

Form 7

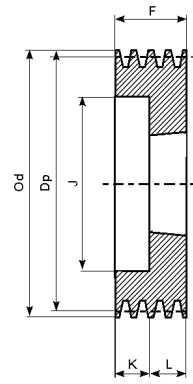

Form 9

SPZ - 1

Description	Dp.	Od.	Form	Bush No.	Max Bore	E	F	J	K	L	M	N
SPZ 50 - 1	50	54	9	1008	25		37	28	15.0	22		
SPZ 56 - 1	56	60	9	1008	25		37	23	15.0	22		
SPZ 60 - 1	60	64	9	1008	25		22			22		
SPZ 63 - 1	63	67	1	1108	28		16			22	6.0	62
SPZ 67 - 1	67	71	1	1108	28		16			22	6.0	62
SPZ 71 - 1	71	75	1	1108	28		16			22	6.0	62
SPZ 75 - 1	75	79	1	1108	28		16			22	6.0	62
SPZ 80 - 1	80	84	1	1210	32		16			25	9.0	75
SPZ 85 - 1	85	89	1	1210	32		16			25	9.0	75
SPZ 90 - 1	90	94	1	1210	32		16			25		75
SPZ 95 - 1	95	99	1	1210	32		16			25	9.0	75
SPZ 100 - 1	100	10	1	1210	32		16			25	9.0	75
SPZ 106 - 1	106	11	1	1610	42		16			25	9.0	80
SPZ 112 - 1	112	11	1	1610	42		16			25	9.0	80
SPZ 118 - 1	118	12	1	1610	42		16			25	9.0	80
SPZ 125 - 1	125	12	1	1610	42		16			25	9.0	80
SPZ 132 - 1	132	13	1	1610	42		16			25	9.0	80
SPZ 140 - 1	140	14	1	1610	42		16			25	9.0	80
SPZ 150 - 1	150	15	1	1610	42		16			25	9.0	80
SPZ 160 - 1	160	16	1	1610	42		16			25	9.0	80
SPZ 170 - 1	170	17	1	1610	42		16			25	9.0	80
SPZ 180 - 1	180	18	1	1610	42		16			25	9.0	80
SPZ 190 - 1	190	19	7	1610	42		16	161		25	9.0	80
SPZ 200 - 1	200	20	7	2012	50		16	172		32	16.0	100
SPZ 224 - 1	224	22	7	2012	50	15	16	196		32	16.0	100
SPZ 250 - 1	250	25	4	2012	50		16	222	8.0	32	8.0	100
SPZ 280 - 1	280	28	4	2012	50		16	252	8.0	32	8.0	100
SPZ 315 - 1	315	31	4	2012	50		16	287	8.0	32	8.0	100
SPZ 355 - 1	355	35	4	2012	50		16	326	8.0	32	8.0	112
SPZ 400 - 1	400	40	4	2012	50		16	371	8.0	32	8.0	112
SPZ 450 - 1	450	45	4	2517	60		16	421	14.5	45	14.5	120

V Belt Pulleys SPZ | Taper Bush to ISO4183 and DIN2211

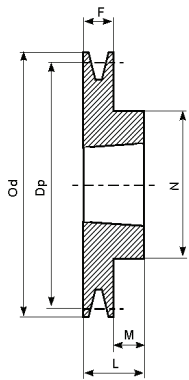

Form 1

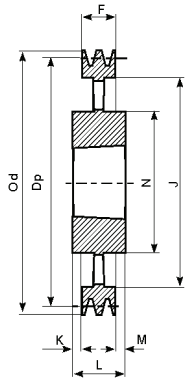

Form 4

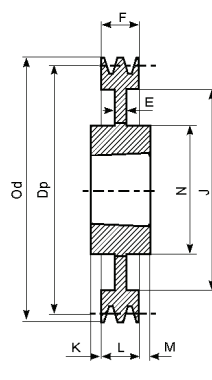

Form 7

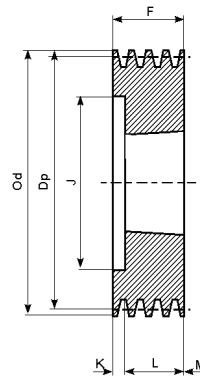

Form 8

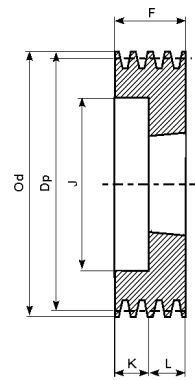

Form 9

SPZ - 2

Description	Dp.	Od.	Form	Bush No.	Max Bore	E	F	J	K	L	M	N
SPZ 50 - 2	50	54	9	1008	25		49	28	27.0	22		
SPZ 56 - 2	56	60	9	1108	28		49	35	27.0	22		
SPZ 60 - 2	60	64	9	1108	28		49	36	27.0	22		
SPZ 63 - 2	63	67	8	1108	28		28	40	6.0	22		
SPZ 67 - 2	67	71	8	1108	28		28	42	6.0	22		
SPZ 71 - 2	71	75	8	1108	28		28	42	6.0	22		
SPZ 75 - 2	75	79	8	1210	32		28	51	3.0	25		
SPZ 80 - 2	80	84	8	1210	32		28	51	3.0	25		
SPZ 85 - 2	85	89	8	1610	42		28	60	3.0	25		
SPZ 90 - 2	90	94	8	1610	42		28	61	3.0	25		
SPZ 95 - 2	95	99	8	1610	42		28	66	3.0	25		
SPZ 100 - 2	100	104	8	1610	42		28	71	3.0	25		
SPZ 106 - 2	106	110	8	1610	42		28	76	3.0	25		
SPZ 112 - 2	112	116	8	1610	42		28	84	3.0	25		
SPZ 118 - 2	118	122	8	1610	42		28	90	3.0	25		
SPZ 125 - 2	125	129	8	1610	42		28	97	3.0	25		
SPZ 132 - 2	132	136	8	1610	42		28	104	3.0	25		
SPZ 140 - 2	140	146	8	1610	42		28	115	3.0	25		
SPZ 150 - 2	150	154	1	2012	50		28			32	4.0	100
SPZ 160 - 2	160	164	1	2012	50		28			32	4.0	100
SPZ 170 - 2	170	174	1	2012	50		28			32	4.0	100
SPZ 180 - 2	180	184	7	2012	50	10	28	152		32	4.0	100
SPZ 190 - 2	190	194	7	2012	50	10	28	161		32	4.0	100
SPZ 200 - 2	200	204	7	2012	50	10	28	171		32	4.0	100
SPZ 224 - 2	224	228	7	2012	50	10	28	196		32	4.0	100
SPZ 250 - 2	250	254	4	2012	50		28	222	2.0	32	2.0	100
SPZ 280 - 2	280	284	4	2012	50		28	252	2.0	32	2.0	100
SPZ 315 - 2	315	319	4	2012	50		28	286	2.0	32	2.0	100
SPZ 355 - 2	355	359	4	2012	50		28	326	2.0	32	2.0	112
SPZ 400 - 2	400	404	4	2517	50		28	371	8.5	45	8.5	120
SPZ 450 - 2	450	454	4	2517	60		28	421	8.5	45	8.5	120

V Belt Pulleys SPA | Taper Bush to ISO4183 and DIN2211

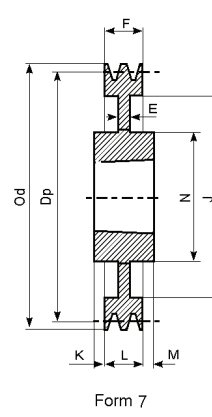
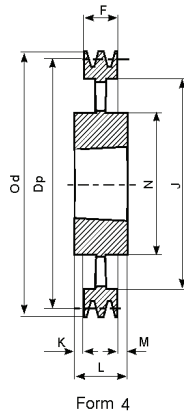
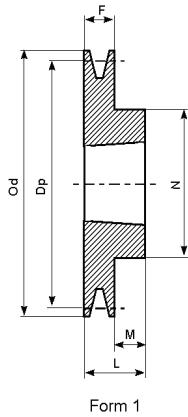

SPA - 1

Description	Dp.	Od.	Form	Bush No.	Max Bore	E	F	J	K	L	M	N
SPA 63 - 1	63	68.5	9	1108	28		40	38	18	22		
SPA 67 - 1	67	72.5	1	1108	28		20	38		22	2	62
SPA 71 - 1	71	76.5	1	1108	28		20			22	2	62
SPA 75 - 1	75	80.5	1	1108	28		20			22	5	62
SPA 80 - 1	80	85.5	1	1210	32		20			25	5	75
SPA 85 - 1	85	90.5	1	1210	32		20			25	5	75
SPA 90 - 1	90	95.5	1	1210	32		20			25	5	75
SPA 95 - 1	95	100.5	1	1210	32		20			25	5	75
SPA 100 - 1	100	105.5	1	1610	42		20			25	5	80
SPA 106 - 1	106	111.5	1	1610	42		20			25	5	80
SPA 112 - 1	112	117.5	1	1610	42		20			25	5	80
SPA 118 - 1	118	123.5	1	1610	42		20			25	5	80
SPA 125 - 1	125	130.5	1	1610	42		20			25	5	80
SPA 132 - 1	132	137.5	1	1610	42		20			25	5	80
SPA 140 - 1	140	145.5	1	1610	42		20			25	5	80
SPA 150 - 1	150	155.5	1	1610	42		20			25	5	80
SPA 160 - 1	160	165.5	1	1610	42		20			25	5	80
SPA 170 - 1	170	175.5	1	1610	42		20			25	5	80
SPA 180 - 1	180	185.5	1	1610	42		20			25	5	80
SPA 190 - 1	190	195.5	1	1610	42		20			25	5	80
SPA 200 - 1	200	205.5	7	2012	50	10	20	165		32	12	100
SPA 224 - 1	224	229.5	7	2012	50	10	20	189		32	12	100
SPA 250 - 1	250	255.5	7	2012	50	10	20	215	6	32	6	100
SPA 280 - 1	280	285.5	7	2012	50	10	20	245		32	12	100
SPA 315 - 1	315	320.5	4	2012	50		20	280		32	12	100
SPA 355 - 1	355	360.5	4	2012	50		20	320		32	12	100
SPA 400 - 1	400	405.5	4	2012	50		20	365		32	12	100
SPA 450 - 1	450	455.5	4	2012	50		20	415		32	12	100
SPA 500 - 1	500	505.5	4	2517	60		20	465		45	25	120
SPA 630 - 1	630	635.5	4	2517	60		20	595		45	25	120

V Belt Pulleys SPA | Taper Bush to ISO4183 and DIN2211

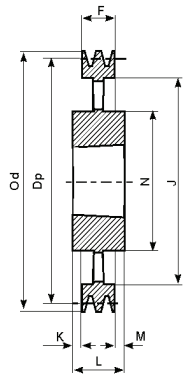

Form 4

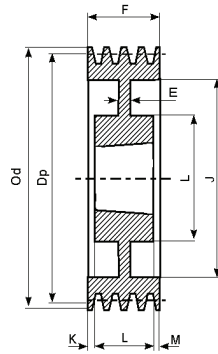

Form 6

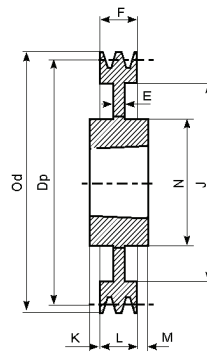

Form 7

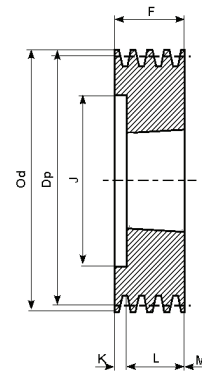

Form 8

SPA - 2

Description	Dp.	Od.	Form	Bush No.	Max Bore	E	F	J	K	L	M	N
SPA 63x2	63	68.5	8	1008	28		35	32.5	13.0	22		
SPA 67x2	67	72.5	8	1108	28		35	37.0	13.0	22		
SPA 71x2	71	76.5	8	1108	28		35	40.0	13.0	22		
SPA 75x2	75	80.5	8	1108	28		35	44.0	13.0	25		
SPA 80x2	80	85.5	8	1210	32		35	50.0	10.0	25		
SPA 85x2	85	90.5	8	1210	32		35	55.0	10.0	25		
SPA 90x2	90	95.5	8	1610	42		35	59.0	10.0	25		
SPA 95x2	95	100.5	8	1610	42		35	63.0	10.0	25		
SPA 100x2	100	105.5	8	1610	42		35	66.0	10.0	25		
SPA 106x2	106	111.5	8	1610	42		35	72.0	10.0	25		
SPA 112x2	112	117.5	8	1610	42		35	78.0	10.0	25		
SPA 118x2	118	123.5	8	1610	42		35	84.0	10.0	25		
SPA 125x2	125	130.5	8	1610	42		35	91.0	10.0	25		
SPA 132x2	132	137.5	8	2012	50		35	98.0	3.0	32		
SPA 140x2	140	145.5	8	2012	50		35	106.0	3.0	32		
SPA 150x2	150	155.5	8	2012	50		35	116.0	3.0	32		
SPA 160x2	160	165.5	8	2012	50		35	125.0	3.0	32		
SPA 170x2	170	175.5	8	2012	50		35	135.0	3.0	32		
SPA 180x2	180	185.5	6	2012	50	10	35	146.0	1.5	32	1.5	108
SPA 190x2	190	195.5	6	2012	50	6	35	156.0		32	3.0	108
SPA 200x2	200	205.5	7	2517	60	10	35	165.0	5.0	45	5.0	123
SPA 212x2	212	217.5	7	2517	60	18	35	177.0	5.0	45	5.0	123
SPA 224x2	224	229.5	7	2517	60	18	35	189.0		45	10.0	124
SPA 236x2	236	241.5	7	2517	60	12	35	202.0		45	10.0	124
SPA 250x2	250	255.5	7	2517	60	12	35	215.0	5.0	45	5.0	124
SPA 280x2	280	285.5	7	2517	60	12	35	245.0		45	10.0	124
SPA 315x2	315	320.5	7	2517	60	12	35	280.0		45	10.0	124
SPA 355x2	355	360.5	4	2517	60		35	320.0		45	10.0	124
SPA 400x2	400	405.5	4	2517	60		35	365.0		45	10.0	124
SPA 450x2	450	455.5	4	2517	60		35	465.0		45	10.0	124
SPA 500x2	500	505.5	4	2517	60		35	525.0		45	10.0	125
SPA 630x2	630	635.5	4	3020	75		35	595.0	8.0	51	18.0	159

V Belt Pulleys SPB | Taper Bush to ISO4183 and DIN2211

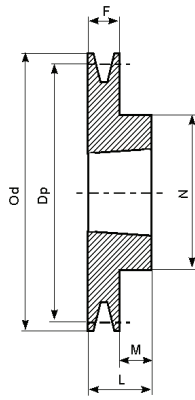

Form 1

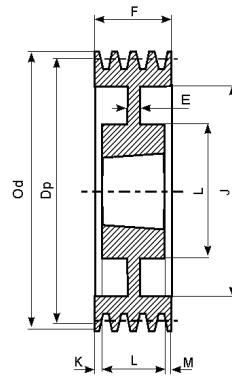

Form 6

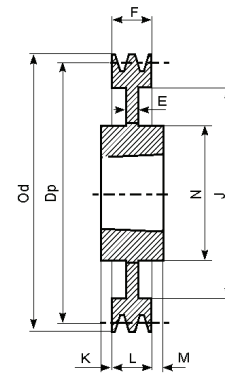

Form 7

SPB - 1

Description	Dp.	Od.	Form	Bush No.	Max Bore	E	F	J	K	L	M	N
SPB 100x1	100	107	1	1610	42		25			25		
SPB 106x1	106	113	1	1610	42		25			25		
SPB 112x1	112	119	1	1610	42		25			25		
SPB 118x1	118	125	1	1610	42		25			25		
SPB 125x1	125	132	1	1610	42		25			25		
SPB 132x1	132	139	1	1610	42		25			25		
SPB 140x1	140	147	1	1610	42		25			25		
SPB 150x1	150	157	1	1610	42		25			25		
SPB 160x1	160	167	1	1610	42		25			25		
SPB 170x1	170	177	1	1610	42		25			25		
SPB 180x1	180	187	6	1610	42	15	25	132		25		90
SPB 190x1	190	197	7	2012	50	15	25	147	3.5	32	3.5	104
SPB 200x1	200	207	7	2012	50	15	25	157	3.5	32	3.5	104
SPB 212x1	212	219	7	2012	50	15	25	169	3.5	32	3.5	104
SPB 224x1	224	231	7	2012	50	15	25	181	3.5	32	3.5	104
SPB 236x1	236	243	7	2012	50	15	25	193	3.5	32	3.5	104
SPB 250x1	250	257	7	2012	50	20	25	207	3.5	32	3.5	104
SPB 280x1	280	287	7	2012	50	20	25	237	3.5	32	3.5	104
SPB 300x1	300	307	7	2012	50	20	25	257	3.5	32	3.5	104
SPB 315x1	315	322	7	2012	50	20	25	272	3.5	32	3.5	104

V Belt Pulleys SPB | Taper Bush to ISO4183 and DIN2211

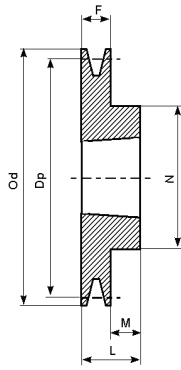

Form 1

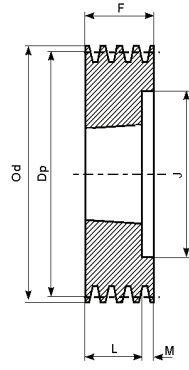

Form 2

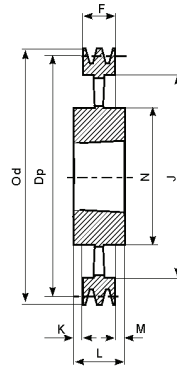

Form 4

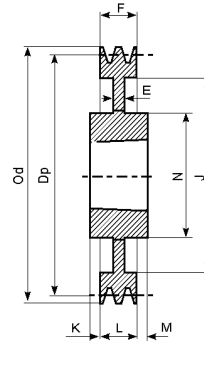

Form 7

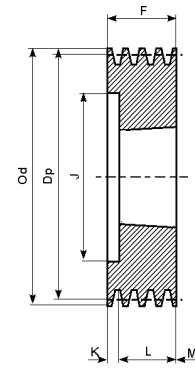

Form 8

SPB - 2

Description	Dp.	Od.	Form	Bush No.	Max Bore	E	F	J	K	L	M	N
SPB 100x2	100	107	8	1610	42		44	62	19.0	25		
SPB 106x2	106	113	8	1610	42		44	67	19.0	25		
SPB 112x2	112	119	8	1610	42		44	72	19.0	25		
SPB 118x2	118	125	2	1610	42		44	78		25	19.0	
SPB 125x2	125	132	2	2012	50		44	82		32	12.0	
SPB 132x2	132	139	2	2012	50		44	89		32	12.0	
SPB 140x2	140	147	2	2012	50		44	97		32	12.0	
SPB 150x2	150	157	2	2012	50		44	107		32	12.0	
SPB 160x2	160	167	2	2012	50		44	117		32	12.0	
SPB 170x2	170	177	2	2012	50		44	127		32	12.0	
SPB 180x2	180	187	1	2517	60		44			45	1.0	120
SPB 190x2	190	197	1	2517	60		44			45	1.0	120
SPB 200x2	200	207	1	2517	60		44			45	1.0	117
SPB 212x2	212	219	7	2517	60	20	44	169		45	1.0	117
SPB 224x2	224	231	7	2517	60	15	44	181		45	1.0	117
SPB 236x2	236	243	7	2517	60	15	44	193		45	1.0	117
SPB 250x2	250	257	7	2517	60	20	44	207		45	1.0	125
SPB 280x2	280	287	7	2517	60	20	44	237		45	1.0	125
SPB 300x2	300	307	7	2517	60	20	44	257		45	1.0	125
SPB 315x2	315	322	7	2517	60	20	44	272		45	1.0	125
SPB 335x2	335	342	7	2517	60	20	44	292		45	1.0	125
SPB 355x2	355	362	7	3020	75	15	44	312	3.5	51	3.5	144
SPB 400x2	400	407	4	3020	75		44	357	3.5	51	3.5	150
SPB 450x2	450	457	4	3020	75		44	407	3.5	51	3.5	150
SPB 500x2	500	507	4	3020	75		44	457	3.5	51	3.5	150
SPB 560x2	560	567	4	3030	75		44	517	4.0	76	28.0	150
SPB 630x2	630	637	4	3030	75		44	587	16.0	76	16.0	150

V Belt Pulleys SPC | Taper Bush to ISO4183 and DIN2211

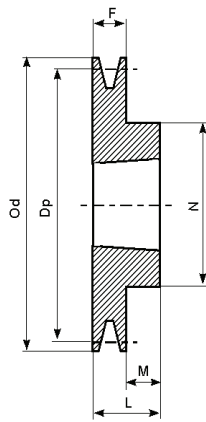

Form 1

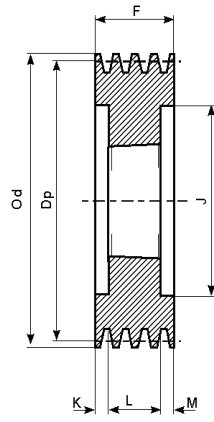

Form 3

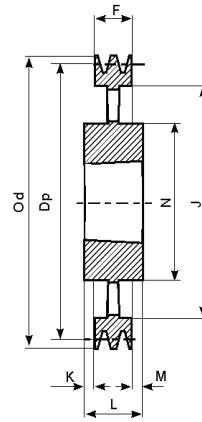

Form 4

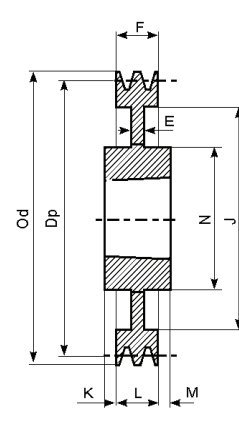

Form 7

SPC - 3

Description	Dp.	Od.	Form	Bush No.	Max Bore	E	F	J	K	L	M	N
SPC 200x3	200	209.6	3	2517	60		85	144	20.0	45	20.0	
SPC 212x3	212	221.6	3	3020	75		85	156	17.0	51	17.0	
SPC 224x3	224	233.6	3	3020	75		85	168	17.0	51	17.0	
SPC 236x3	236	245.6	3	3020	75		85	180	17.0	51	17.0	
SPC 250x3	250	259.6	3	3020	75		85	194	17.0	51	17.0	
SPC 265x3	265	274.6	1	3535	90		85	209		89	4.0	175
SPC 280x3	280	289.6	1	3535	90		85	224		89	4.0	175
SPC 300x3	300	309.6	7	3535	90	20	85	244	2.0	89	2.0	175
SPC 315x3	315	324.6	7	3535	90	20	85	259	2.0	89	2.0	175
SPC 335x3	335	344.6	7	3535	90	20	85	279	2.0	89	2.0	175
SPC 355x3	355	364.6	7	3535	90	20	85	299	2.0	89	2.0	175
SPC 375x3	375	384.6	7	3535	90	25	85	319	2.0	89	2.0	175
SPC 400x3	400	409.6	7	3535	90	17	85	344	2.0	89	2.0	175
SPC 425x3	425	434.6	7	3535	90	17	85	369	2.0	89	2.0	175
SPC 450x3	450	459.6	4	3535	90		85	394	2.0	89	2.0	175
SPC 475x3	475	484.6	4	3535	90		85	419	2.0	89	2.0	175
SPC 500x3	500	509.6	4	3535	90		85	444	2.0	89	2.0	175
SPC 530x3	530	539.6	4	3535	90		85	474	2.0	89	2.0	175
SPC 560x3	560	569.6	4	3535	90		85	504	2.0	89	2.0	175
SPC 630x3	630	639.6	4	4040	100		85	574	8.5	102	8.5	210
SPC 800x3	800	809.6	4	4545	110		85	737	14.5	114	14.5	242
SPC 1000x3	1000	1009.6	4	5050	125		85	937	21.0	127	21.0	267
SPC 1250x3	1250	1259.6	4	5050	125		85	1187	21.0	127	21.0	267

V Belt Pulleys SPC | Taper Bush to ISO4183 and DIN2211

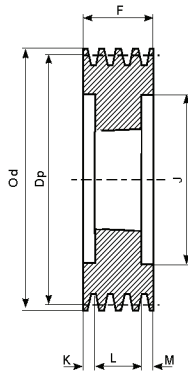

Form 3

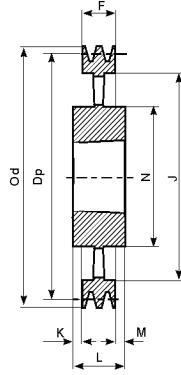

Form 4

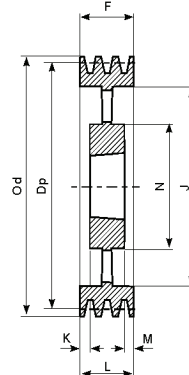

Form 5

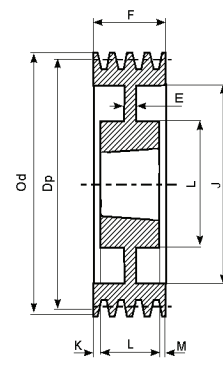

Form 6

SPC - 4

Description	Dp.	Od.	Form	Bush No.	Max Bore	E	F	J	K	L	M	N
SPC 200x4	200	209.6	3	3020	75		111	144	30.0	51	30.0	
SPC 212x4	212	221.6	3	3020	75		111	156	30.0	51	30.0	
SPC 224x4	224	233.6	3	3535	90		111	168	11.0	89	11.0	
SPC 236x4	236	245.6	3	3535	90		111	180	11.0	89	11.0	
SPC 250x4	250	259.6	3	3535	90		111	194	11.0	89	11.0	
SPC 265x4	265	274.6	3	3535	90		111	209	11.0	89	11.0	
SPC 280x4	280	289.6	6	3535	90	18	111	224	11.0	89	11.0	175
SPC 300x4	300	309.6	6	3535	90	20	111	244	11.0	89	11.0	175
SPC 315x4	315	324.6	6	3535	90	20	111	259	11.0	89	11.0	175
SPC 335x4	335	344.6	6	3535	90	20	111	279	11.0	89	11.0	175
SPC 355x4	355	364.6	6	3535	90	20	111	299	11.0	89	11.0	175
SPC 375x4	375	384.6	6	3535	90	25	111	319	11.0	89	11.0	175
SPC 400x4	400	409.6	6	3535	90	18	111	344	11.0	89	11.0	175
SPC 425x4	425	434.6	6	3535	90	18	111	369	11.0	89	11.0	175
SPC 450x4	450	459.6	5	3535	90		111	394	11.0	89	11.0	175
SPC 475x4	475	484.6	5	3535	90		111	419	11.0	89	11.0	175
SPC 500x4	500	509.6	5	3535	90		111	444	11.0	89	11.0	175
SPC 530x4	530	539.6	5	4040	100		111	474	4.5	102	4.5	210
SPC 560x4	560	569.6	5	4040	100		111	504	4.5	102	4.5	210
SPC 630x4	630	639.6	4	4545	110		111	574	1.5	114	1.5	242
SPC 710x4	710	719.6	4	5050	125		111	654	8.0	127	8.0	267
SPC 800x4	800	809.6	4	5050	125		111	737	8.0	127	8.0	267
SPC 1000x4	1000	1009.6	4	5050	125		111	937	8.0	127	8.0	267
SPC 1250x4	1250	1259.6	4	5050	125		111	1187	8.0	127	8.0	267